

Conference flat-rate package: Catering / room hire / technical equipment

For 50 or up to 750 people –
we have the right package for you.

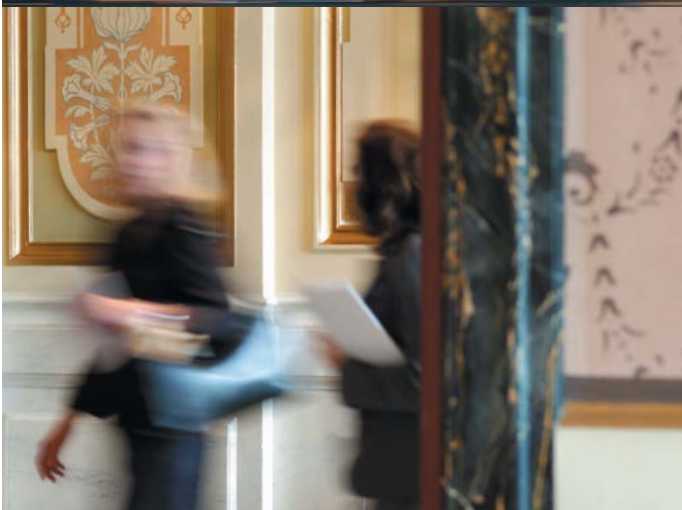

Outstanding meetings.

Welcome to our award-winning historic conference and events centre.

You will find:

- > 100 years of history
- > magnificent architecture
- > multi-functionality
- > state-of-the-art equipment
- > excellent in-house catering by Culinaria
- > easy accessibility with a location in the centre of North Rhine-Westphalia
- > environmentally friendly event planing
- > wide selection of hotels and excellent infrastructure
- > and an outstanding management team who is on hand for every eventuality

On the following pages, you will find our flat-rate charges for conferences and a brief overview of the rooms.

We would be pleased to help you with the selection of the right room. We would also be delighted to work out a flat-rate for individual requirements.



Conference flat-rate package: catering / room hire / technical equipment

We offer five conference flat-rates in five rooms
tiered by the number of guests.

CLIC, CLIC, CONFERENCE
Request your flat-rate and
desired date here [online](#)

NUMBER OF PARTICIPANTS	FLAT RATE	ROOM
up to 50	79.50 euros / person	Hindemith Saal
50 – 100	65.50 euros / person	Mahler Saal
100 – 200	57 euros / person	Offenbach Saal
200 – 350	60 euros / person	Mendelssohn Saal
350 – 750	70.50 euros / person	Grosser Saal

PRICES INCLUDE THE FOLLOWING SERVICES

FOR UP TO 10 HOURS (MAX.)

Standard catering

2 x coffee breaks with coffee, tea, soft drinks and
snacks/lunch snack buffet (starter and main course) /
soft drinks with the snack buffet

Room hire / technical equipment (50 – 750 people)

Room hire by day / row or chevron-style seating / audio
equipment / sound control / lectern / 2 x lectern microphone /
podium monitoring / DI box / 1 x transmission chain
(hand transmitter/headset etc.) / projection set / laptop /
presentation toolkit incl. Varioboard / pad and pen per person /
bar tables / daily rate for technician

(from 200-350 people)

cloakroom personnel (Culinaria)

(from 350-750 people)

cloakroom personnel (Culinaria) / additional bar tables (10) /
First-aid service

Flat rate (plus VAT)

We would be happy to offer all additionally used rooms at the standard rate of hire (Status 03.2020)

Our rooms

HINDEMITH SAAL (max. 50 people | 79.50 euros / person)

FIRST FLOOR

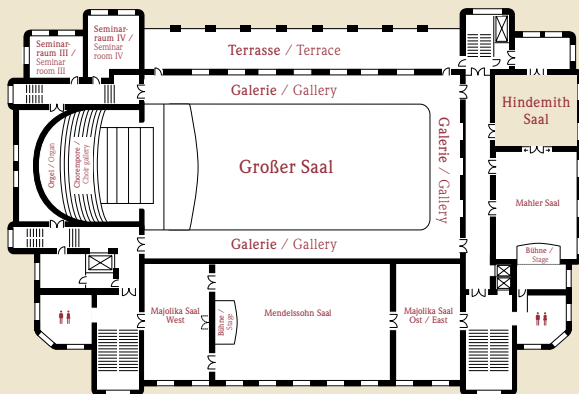

Thanks to their dimensions, the blue Hindemith Saal and the red Mahler Saal and are ideal for smaller more exclusive events – conferences, lectures, presentations, family parties or cultural events.

Both rooms are also multifunctional and can be used together or separately.



Our rooms

MAHLER SAAL (max. 100 people | 65.50 euros / person)

FIRST FLOOR

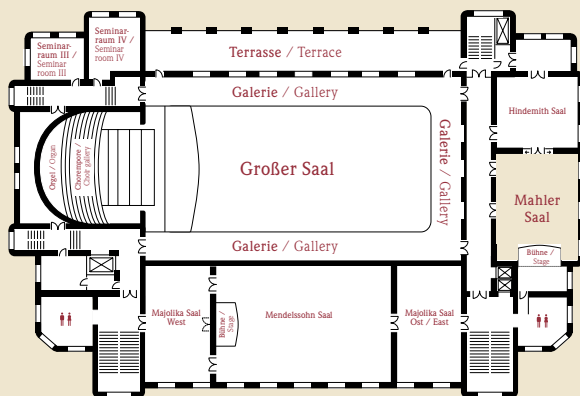

Thanks to their dimensions, the red Mahler Saal and the blue Hindemith Saal are ideal for smaller more exclusive events – conferences, lectures, presentations, family parties or cultural events.

Both rooms are also multifunctional and can be used together or separately.

Furthermore, the Mahler Saal is equipped with a stage.



Our rooms

OFFENBACH SAAL (max. 200 people | 57 euros / person)

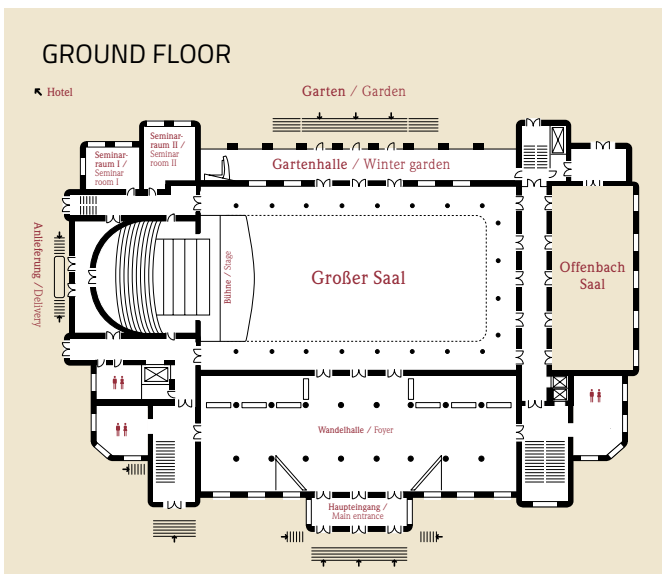

Designed over a 100 years ago for elegant banquets, the Offenbach Saal continues to be eminently suitable for dinners and celebrations, banquets, buffets or as a "Party Zone".

Today, it is also the setting for successful conferences, seminars, lectures, trade fairs and meetings.



Our rooms

MENDELSSOHN SAAL (max. 350 people | 60 euros / person)

FIRST FLOOR

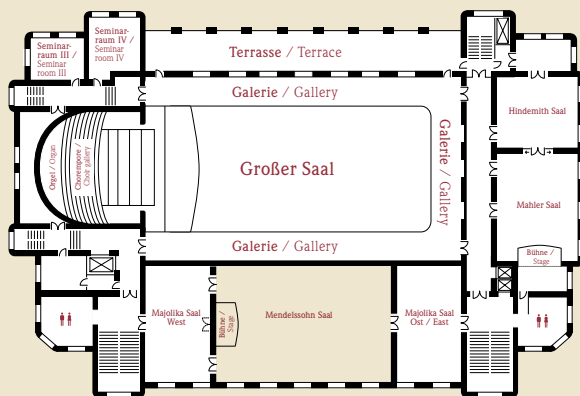

The Mendelssohn Saal is the second-largest room in the building. Used on its own or in combination with the neighbouring Majolika Saal, it gives free rein to the inspiration of planners of conferences, seminars, exhibitions, chamber concerts or parties.

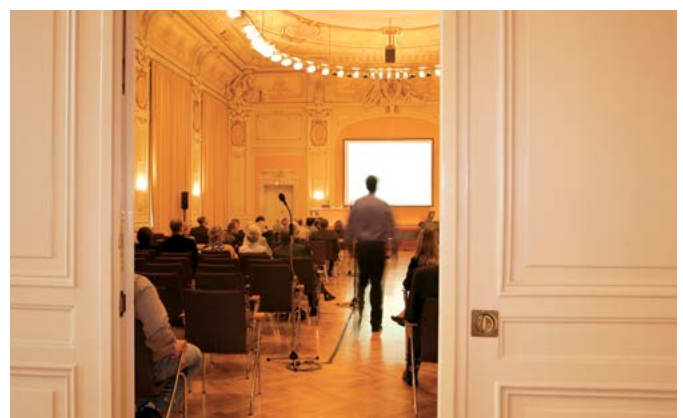
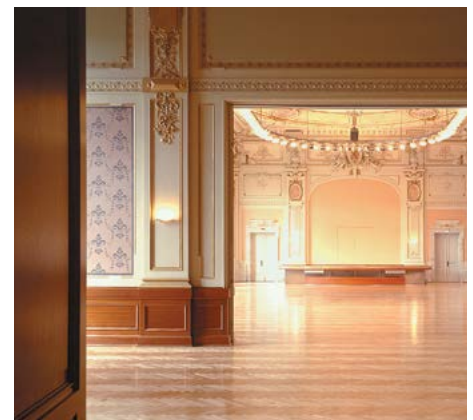

Our rooms

GROSSER SAAL (max. 1.000 people | 70.50 euros / person)

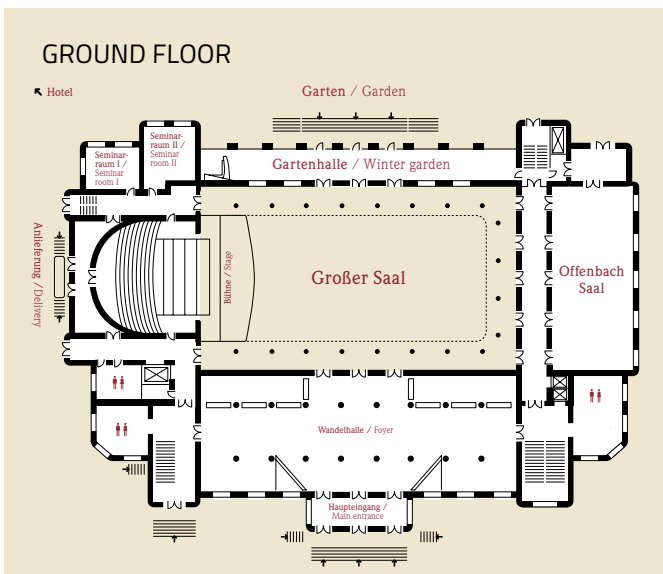

The Großer Saal is the heart of the Historische Stadthalle. Its impressive height stretches over the two main storeys of the building.

This ambience creates a glittering setting for large conferences, congresses and high-quality presentations, as well as magical galas, balls and cultural events.



Service overview

In addition to our flat rates, we offer the full spectrum of professional planning for congresses and events.

Below is an overview of the services we offer.

FACILITIES

- > 3,263 m2 area
- > Capacity for 50 to 4,000 people
- > 8 rooms, foyer and winter garden:
seating for 50 to 1,542 people
- > Garden with 700-m2 marquee area
- > Garden house
- > Barrier-free access
- > lifts
- > Goods lifts
- > Open-air area/garden
- > Parking spaces and multi-storey car park
- > Cloakroom
- > Artists' dressing room
- > Press room
- > Smoking area
- > Conference secretarial services
- > Store/storage rooms
- > Trade-fair construction
- > Rental furniture
- > Air conditioning and daylight
(can be darkened) in all rooms
- > Ground floor fully accessible to vehicles

TECHNICAL FACILITIES

Selected equipment:

- > Line-array PA/sound system (D&B)
- > Riedel Rocknet
- > Digital audio networking
- > Attractive lighting concepts
- > State-of-the-art projection facilities
- > Wi-Fi available in all rooms on request
depending on requirements

ORGANISATION

- > Event management
- > Professional support
- > Room concepts
- > Scheduling and planning
- > Technical support
- > Coordination and procurement
of partner companies such as:
 - > hotels
 - > suppliers of supporting programmes
and entertainment, transportation,
floral decorations, photographers etc.

CATERING

- > Bar and restaurant
- > In-house catering:
 - > Receptions
 - > Gala buffets and banquets
 - > Functions and celebrations
 - > Weddings
 - > Parties
 - > Coffee breaks
 - > Business lunch/dinner
 - > Seminar/meeting package

How to find us

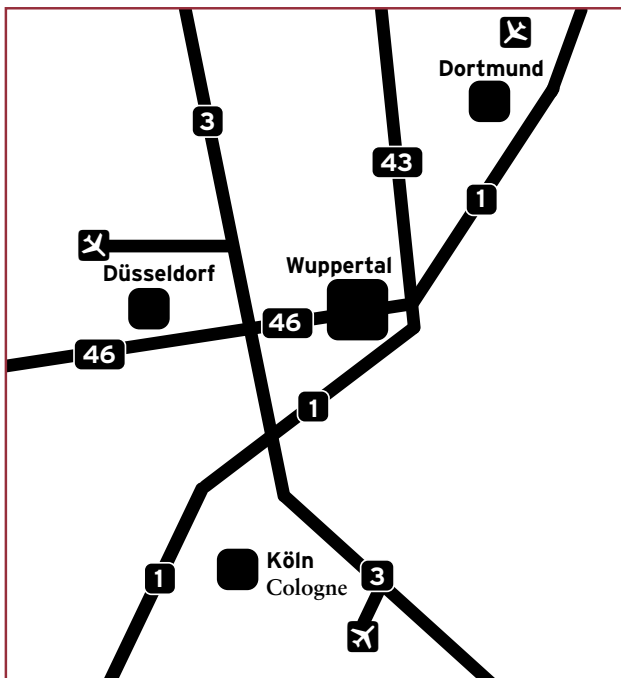

DISTANCES

Wuppertal main railway station: 0.2 km
Düsseldorf International Airport: 35 km
Cologne Bonn Airport: 65 km

The Historische Stadthalle is situated in the heart of North Rhine-Westphalia and in the Wuppertal-Elberfeld town centre.

It is easy to reach by all means of transport from Düsseldorf, Dortmund and Cologne airports.

The main railway station with ICE connections is nearby.

Parking spaces and a multi-storey car park with direct access to the Historische Stadthalle are available. There are numerous other car parks within the vicinity.

Incidentally, the newly renovated "Vienna House Easy Wuppertal Hotel" is right next door. You can choose between the Park Villa and the Golfhotel, budget or boutique establishments. We will be pleased to provide additional information.